

dusitD2 Chiang Mai



dusitD2 Chiang Mai

100 Chang Klan Road,
Chiang Mai 50100, Thailand

t: +66 (0) 53 99 9999
e: d2cm@dusit.com
w: www.dusit.com/d2cm



dusitD2 Chiang Mai

dusitD2 Chiang Mai

dusitD2 Chiang Mai is located just off the famous Chang Klan Road in the heart of downtown, with the city's bustling night bazaar, restaurants and entertainment at its doorstep.

The warm, chic interiors embody the best of contemporary Thai design, and dusitD2's simple, stylish and comfortable rooms provide sanctuaries of comfort and privacy.

A relaxed atmosphere abounds throughout this boutique hotel, from the classical Thai of Café SOI restaurant to the laid-back attitudes on display at Mix Bar or around the outdoor pool. For those looking to wind down, Devarana Spa is the hotel's multi-award-winning spa, while those looking to wind up can do so at DFIT, one of the best-equipped health clubs in Chiang Mai.



Accommodation

130 rooms & suites

- 63 Deluxe Rooms 32 sq m
- 39 Club Deluxe Rooms 32 sq m
- 27 Studio Suites 64 sq m
- 1 D' suite 128 sq m

Dining & Entertainment

- Café SOI restaurant (Thai street food and traditional lanna cuisine)
- Mix bar (For all drink & light refreshment)
- In-Room Dining
- Pool Bar

Guest services & Facilities

- DFIT fitness centre with steam room
- Outdoor swimming pool
- Children's play area
- Devarana spa with 5 treatment rooms
- Safety deposit boxes in-room and at Front Desk
- Conference and banqueting rooms
- Club lounge
- Car park

Meetings & Events

The boardroom (s) and event rooms (m, l) are located in the lower lobby of the hotel; the perfect venue for small seminars, regional meetings, executive meetings to mediumsized conferences. The event rooms have a unique positioning with a pre-function area and breakout rooms. With a seating capacity of up to 142 persons, ideal for cocktail receptions, conferences, parties, coffee / theme breaks, informal gatherings and a pre-function space for exhibitions. State-of-the-art meeting facilities.

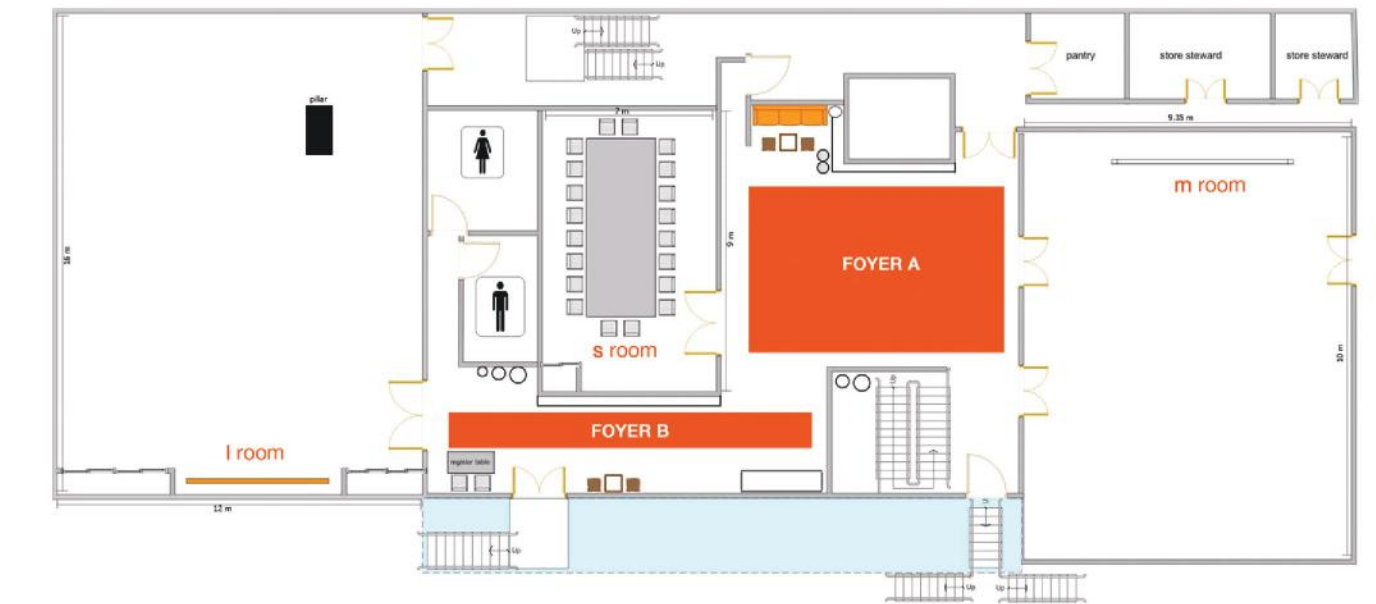

Function room capacity & Dimensions

Room	Area (sq m)	Length (m)	Width (m)	Seating (Upright)	Seating (Theater)	Seating (Banquet)	Seating (Cocktail)	Seating (Standing)
S	6.3	2.8	-	-	-	-	-	16
S + Foyer A	184.75	2.8	-	-	-	-	-	16
M	93.5	2.8	50	98	26	72	40	20
M + Foyer A	215.25	2.8	50	98	26	72	40	20
L	192	2.8	100	146	40	142	68	32
L + Foyer B	262	2.8	100	146	40	142	68	32

